



3 PIECES



3 PIECES

MG24



Design Features

Construction	3 pieces
Installation configuration	Above ground
Dimensions / Size	From 1/4" to 2"
Bore	Full bore or reduced bore
Class / Range	S.800, S.1500, S.3000 e S.6000 / #800, #1500 o #2500
Ends	Flanged / Butt weld or socket weld
Stem retention	Anti blow-out stem
Antistatic device	Continuity between ball and stem
Stem extension	For insulated valves

Valve Operation

Manual	Lever
Automatic	Pneumatic or electric actuator

Material of Construction

Body, ball, stem and seat	Forged low temperature carbon steel, stainless steel, duplex, superduplex o nickel alloys
Sealing	Devlon, Rptfe, Ptfе, Pctfe, Peek, Metal-to-metal (TCC o CCC)
Gasket	O-ring, graphite, rptfe, ptfe o lip-seal

Design Standard

Construction	ASME B16.34, API 6D, API 608, ISO 17292 o ISO 14313
End to end	According to manufacturer standard
End connection	ASME B1.20.1, ISO 228-1, ASME B16.11 o ASME B16.25
Pressure test	API 6D, EN 12266-1 o API 598
Sealing class	ISO 5208 Rate A for soft seats and Rate D for metal-to-metal seats
Fire safe	API 6FA, API 607 or ISO 10497
Safety integrity lever	IEC 61508 or IEC 61511
Pressure Equipment Directive	2014-68-UE
Atmosphères Explosibles	2014-34-UE
Fugitive emission	ISO 15848-1 or ISO 15848-2

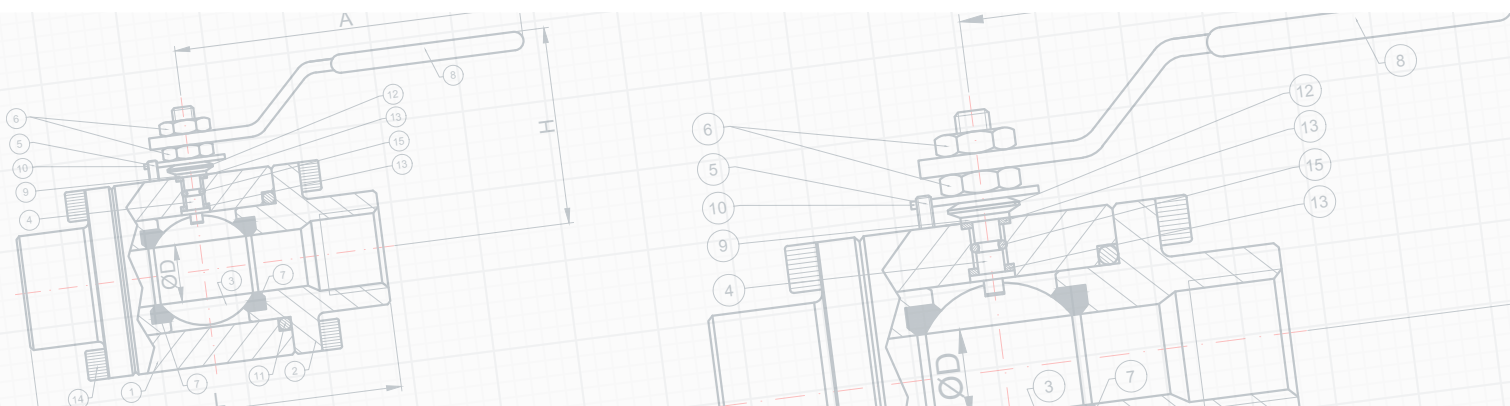

MG24

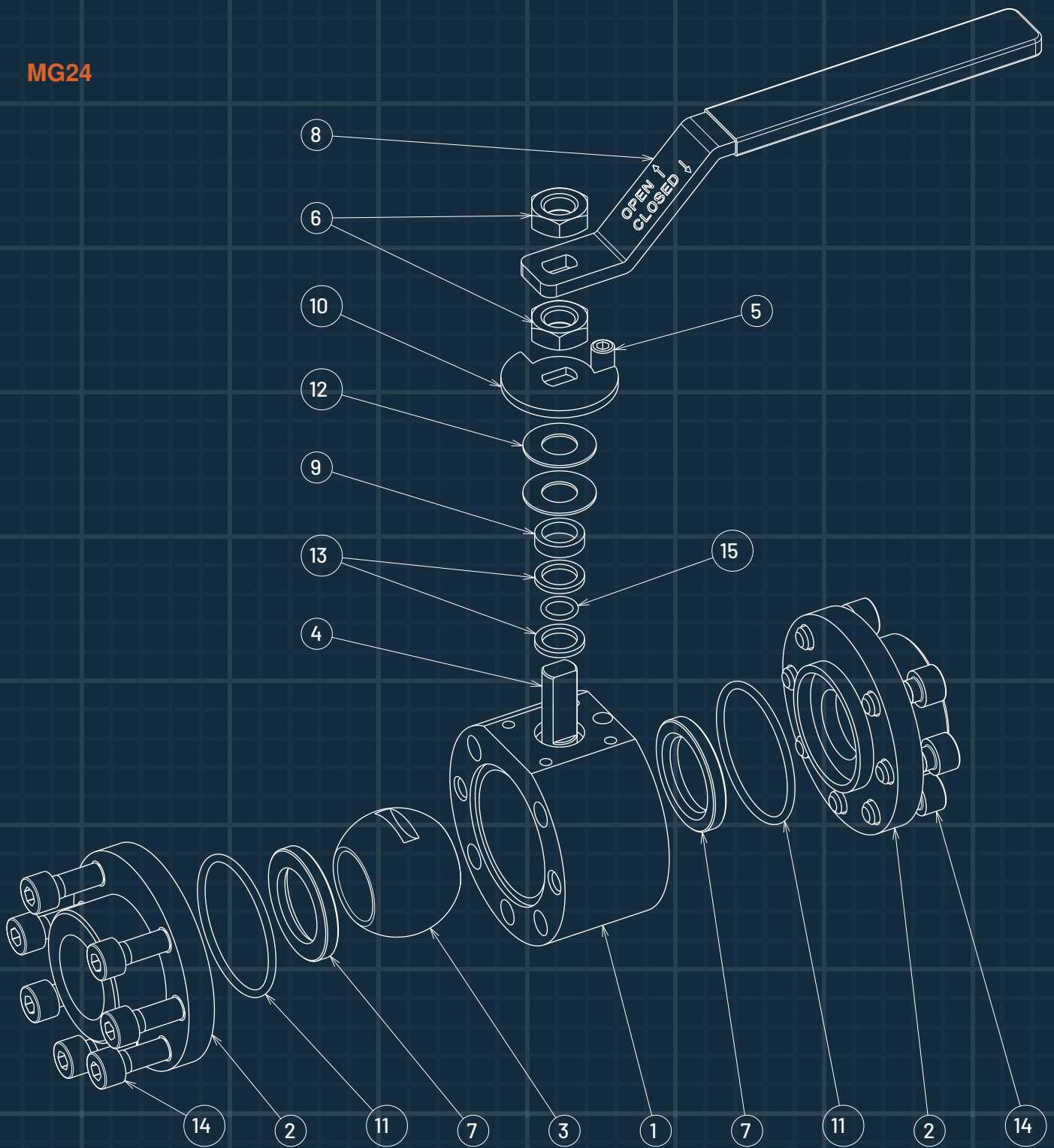

ITEM	DESCRIPTION
1	BODY
2	CLOSURE
3	BALL
4	STEM
5	STOP
6	NUT
7	SEAT
8	LEVER

ITEM	DESCRIPTION
9	PRESSING BUSH
10	STOP
11	BODY SEAL
12	SPRING
13	STEM GASKET
14	BOLTS
15	STEM SEAL



Valves Excellence
For A Lifetime.

+39 0331274109
info@zellinger.it

Headquarters

Via per Gallarate 50/A 21010
Besnate (VA) Italy

Offices and warehouse

Via 2 Giugno, 72 21011
Casorate Sempione (VA) Italy

Manufacturing facility

Via per Cedrate, 942 21044
Cavaria con Premezzo (VA) Italy

Warehouse

Via al Boscaccio 5, 21011
Casorate Sempione (VA) Italy